

# Guide Map of the Experiential Learning Facility GRIN-GRIN Indoor Area

## North Block



A large, open free space surrounded by greenery.

## Central Block



Many plants donated by Ipoh City, our sister city in Malaysia, are exhibited here in a recreation of the natural vegetation of subtropical Malaysia. With 650 pots of orchids on display annually, this space allows our visitors to enjoy orchids all throughout the year.

## South Block



In addition to the colorful plants, flowers, and fruit trees on display in the South Block, our visitors can also enjoy observing aquatic life in the large tanks of aquatic plants and tropical fish also being exhibited.

Admission	Adults (15 years and older): 100 yen Children (6 years and older): 50 yen Children 5 years and younger: Free
Hours	9:00-17:00
Closed	Tuesdays (or the following day if Tuesday is a holiday) 12/29-1/3

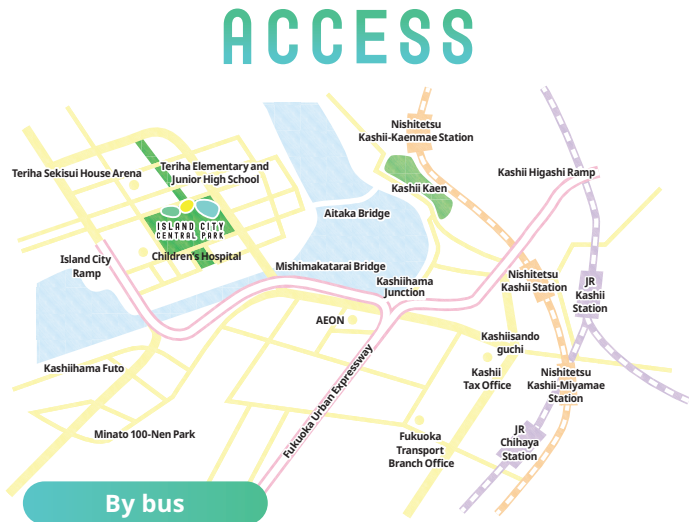
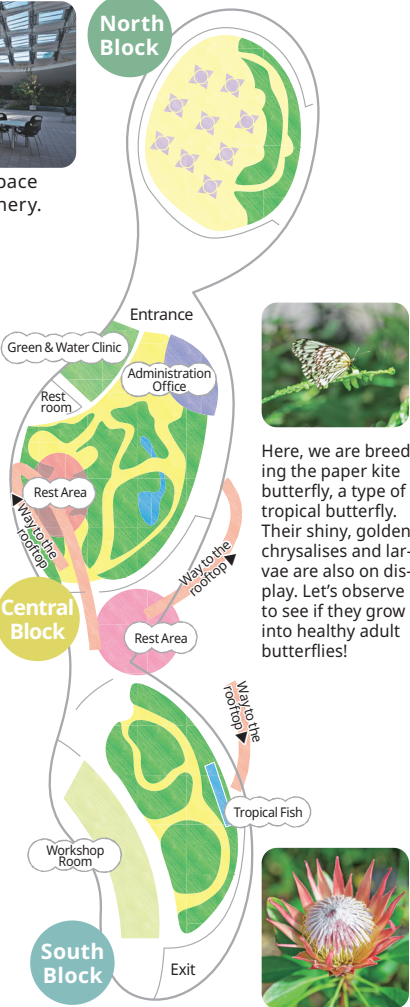

## By bus

From bus stop in front of the Tenjin Post Office, take the bus headed to "Island City". Get off at "Island City Chuo Koen-mae" bus stop.

## By JR Line train

After arriving at Hakata Station by train, go to the Hakata Bus Terminal and take the bus headed to "Island City". Get off at "Island City Chuo Koen-mae" bus stop.

## By Nishitetsu Kaizuka Line train

25 minute walk from Kashioka-Kaenmae Station on the Nishitetsu Kaizuka Line

## By car

Fukuoka Expressway Route No. 6 (Island City Line) Exit the expressway on the "Island City Ramp" and make a right turn at the "Island City Chuo" traffic light, then another right turn at the "Teriha Sekisui House Arena" traffic light.

## Parking (open 24/7 year-round)

### Capacity

Standard-sized car spaces: 293  
Handicapped spaces: 12/Bus spaces: 6

### Rate

1 hour: 100 yen/Up to 500 yen for first 12 hours  
•Free for the first 15 minutes after entering the lot  
•Same rates for buses



Island City Central Park Administration Office  
4-1 Kashioka Teriha, Higashi-ku, Fukuoka City 813-0007  
TEL: 092-661-5980/FAX: 092-672-6925  
Official website: <https://ic-centralpark.jp/>  
Island City Central Park assigned administrator:  
Koyama and FM Fukuoka joint enterprise



# ISLAND CITY CENTRAL PARK





## Follies

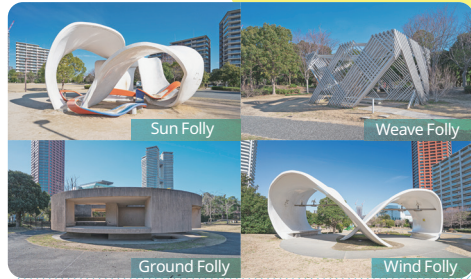

Follies are structures that were popularly used in landscape gardens in the 18th century. They are said to have been named for their eccentricity. Feel free to enjoy and take a rest at the unique follies around the park.  
(\*The Ground Folly is open 9:30-16:00)

## Experiential Learning Facility GRIN-GRIN



Experiential Learning Facility GRIN-GRIN consists of three spaces about 1,000 m<sup>2</sup> each, each with a different interior and theme based on flowers and greenery.

\*See the back of this map for more info.

## GRIN-GRIN Rooftop



Go up to the GRIN-GRIN rooftop from the paid area of the facilities, and from there, you can enjoy a 360-degree panoramic view of not only the park but also the distant mountains, city, and ocean.

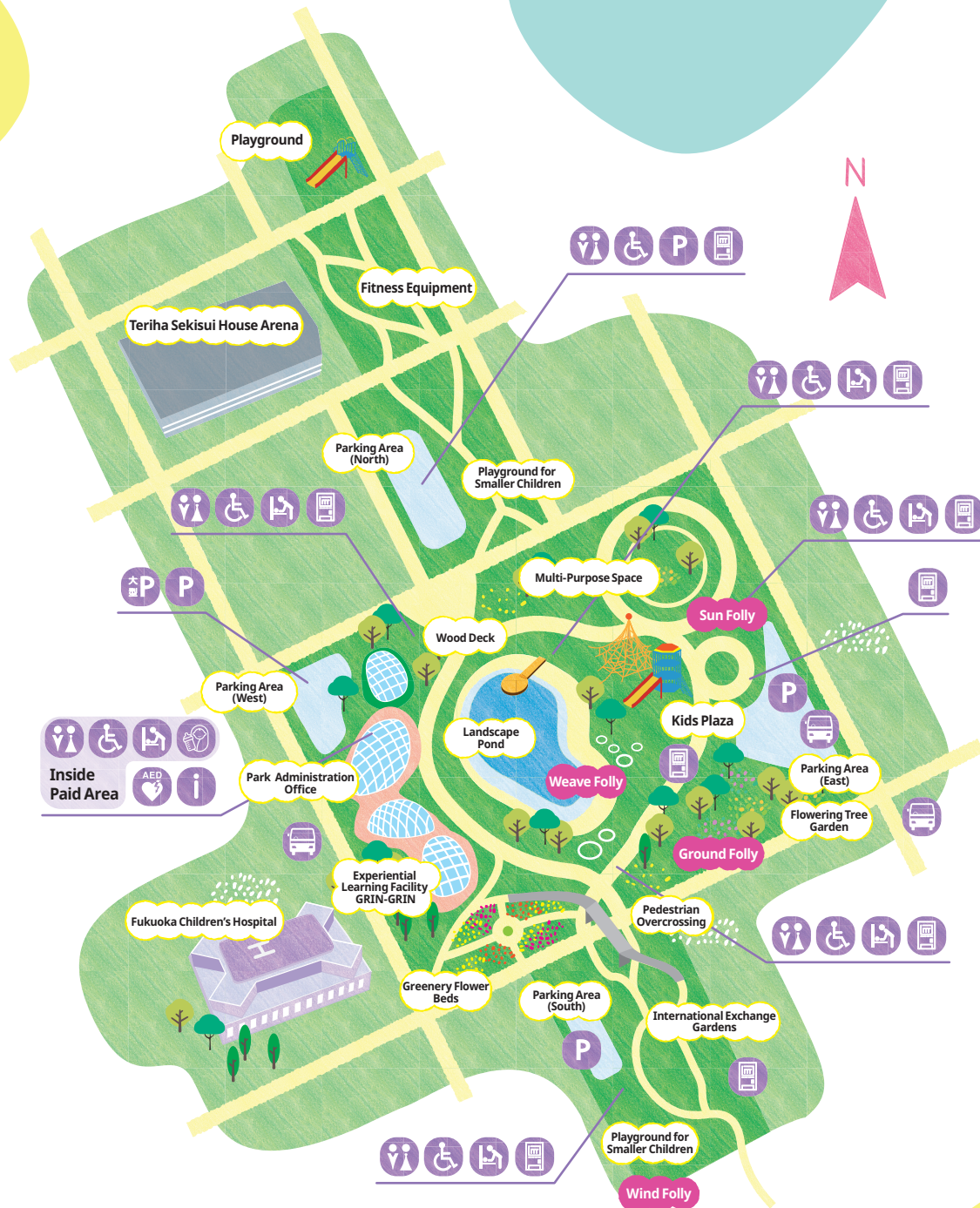

- Public Restroom
- Baby Changing Table
- Receptionist
- AED
- Parking Area for Large Vehicles
- Accessible Restroom
- Nursing Room
- Vending Machine
- Parking Area
- Bus Stop

\*Wheelchairs can be rented at the Park Administration Office

## Multi-Purpose Space



The Multi-Purpose Space is an open lot that can be used freely for play. Within the approximately 90 m and 50 m-large circular grassy areas are a number of benches as well. This space can be used for all kinds of leisure; run around with your kids and play with balls or just spread out a picnic blanket and relax.

## Kids Plaza



The "BIG TREE" is a large playground located near the east parking area. In addition to a large roller slide, it also features four other different-shaped slides, a suspension bridge, spiral stairs, and athletic features. There is also a wide range of other playground equipment for younger children, including steering wheels, grab-and-spin gears, and small slides. The playground surface is made of resilient rubber to ensure safety.

## International Exchange Gardens



Gardens designed after the characteristics of each of Fukuoka City's sister cities, Auckland (USA), Atlanta, Guangzhou, Bordeaux, Auckland (NZ), and Busan Metropolitan City.